



newmap



We help **You** find  
optimal localization  
for **Your** property **investment**

---



new**map**

65 000  
potential clients  
every year

40 000  
uninhabited  
buildings



10 000  
multi-family  
houses



15 000  
uninhabited buildings  
change owner



# What is a **problem** ?

Lack of information  
about property

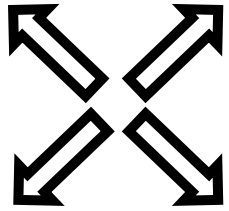

Different sources  
of information



Visits to the offices

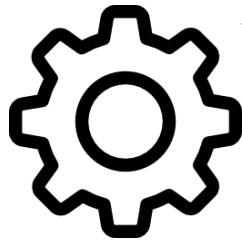

Difficulty in data **integration**

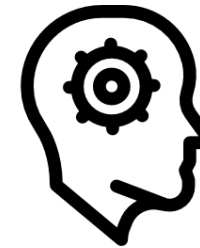

Data **interpretation**

The *solution* is NewMap

3 *easy* steps

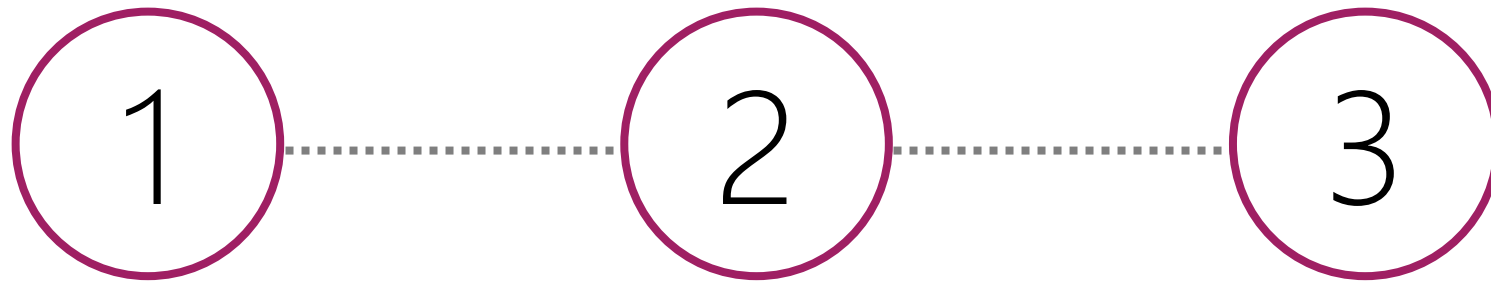

# Choose the property

The screenshot displays the 'newmap' web application interface. At the top, the browser window shows 'New Tab' and the URL 'Tomasz'. The application header includes the 'newmap' logo and navigation icons. The main content area is titled 'Sprawa: Kosakowo-lotnisko (#2017/1)' and features a map of the property with various colored zones (orange, red, green, purple). A hand cursor is positioned over a specific property on the map. To the left of the map, there is a sidebar with the heading 'sekcje raportu' and a list of report sections: 'Dane podstawowe', 'Lokalizacja', 'Użytki gruntowe (50z)', 'Geometria (0z)', 'Własność (0z)', 'Komunikacja i transport', 'Infrastruktura techniczna', and 'Dane geologiczne'. Below the map, there are two buttons: 'Zamów raport' and 'Wróć do listy spraw'. To the right of the map, there is a 'lista działek' table with columns for 'Identyfikator' and 'powierzchnia[ha]'. Below the table, there is a section for 'Uwagi zamawiającego:' with a note: 'Prosimy o wycenę nalotu z kołnierzem 200m'. At the bottom right, there is a section for 'Komentarz newmap:'. The 'newmap' logo is visible at the bottom center of the application.

sekcje raportu

- Dane podstawowe
- + Lokalizacja
- Użytki gruntowe (50z)
- Geometria (0z)
- Własność (0z)
- + Komunikacja i transport
- + Infrastruktura techniczna
- + Dane geologiczne

Sprawa: Kosakowo-lotnisko (#2017/1)

Wyceniona 2017/08/07 6 757,90

lista działek

Identyfikator	powierzchnia[ha]
141915_5_0012402	1.234
141915_5_0012401	21.234
141915_5_0012403	0.234

Uwagi zamawiającego:  
Prosimy o wycenę nalotu z kołnierzem 200m

Komentarz newmap:

Zamów raport

Wróć do listy spraw

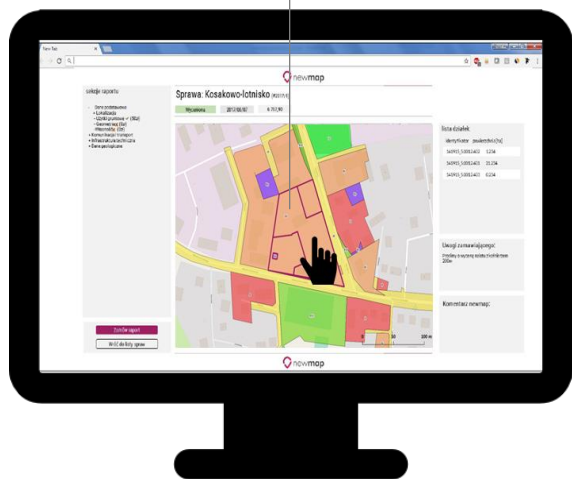

# Pick up the data



Topographic maps

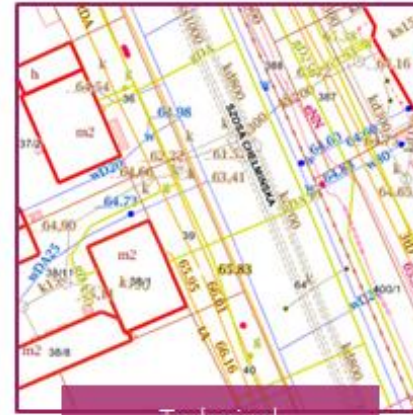

Technical  
infrastructure maps



Geological maps



Orthophotomaps

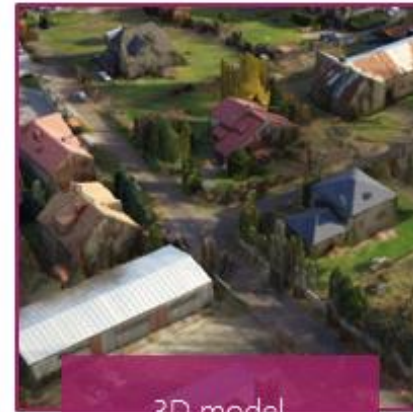

3D model



Local vision

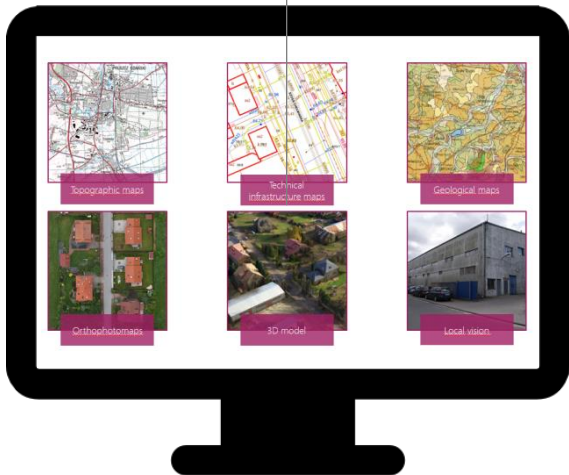

# Get the report

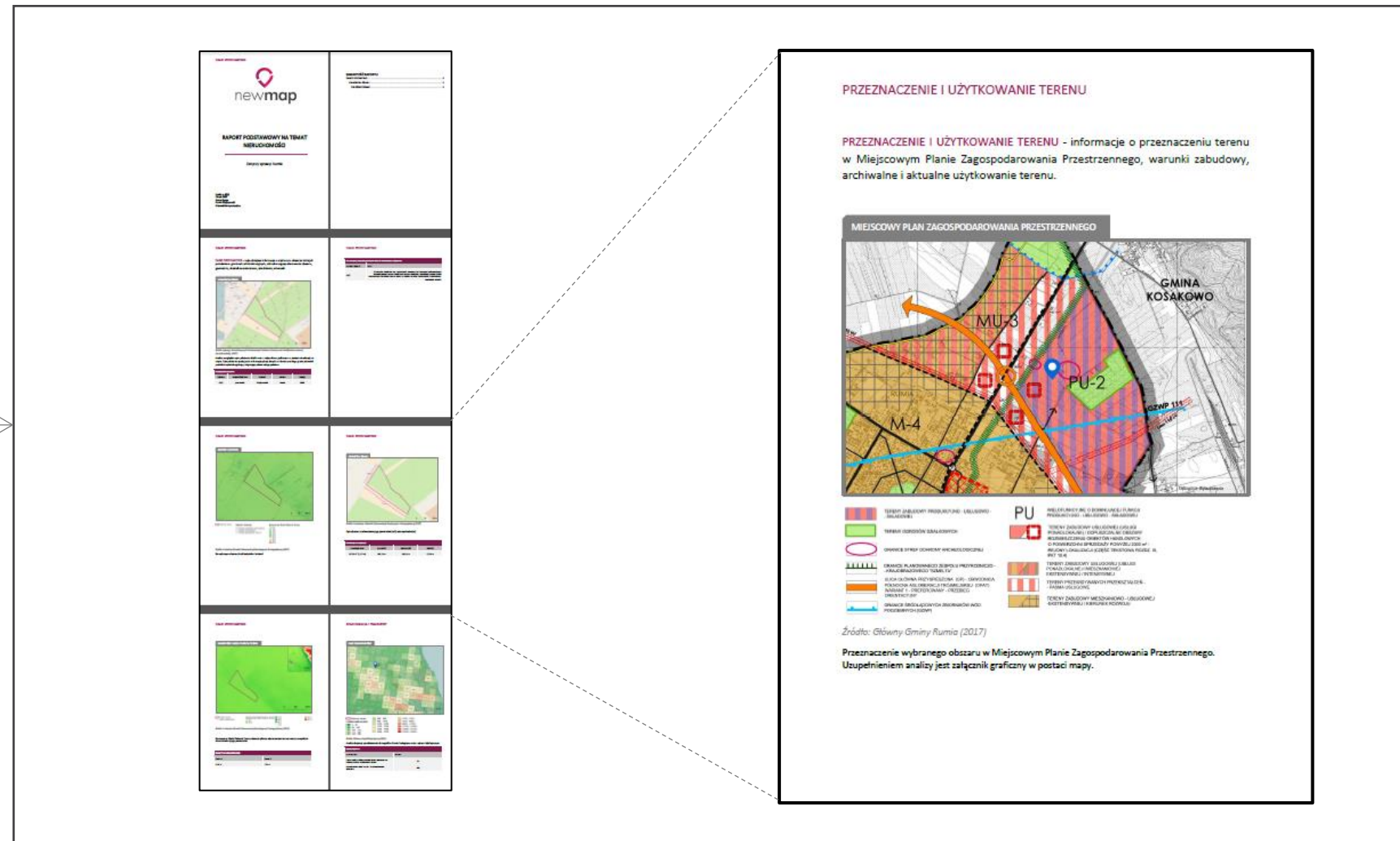
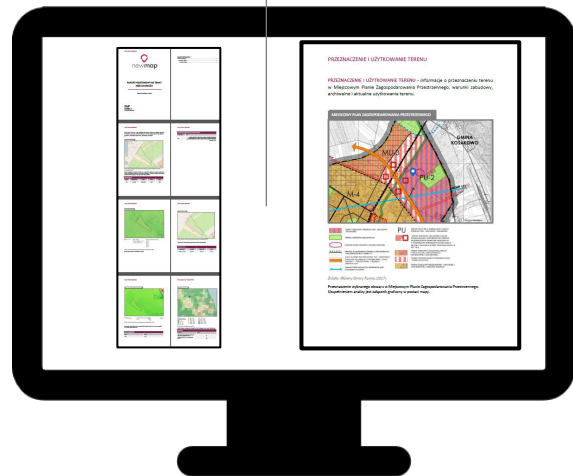



# Benefits



speed

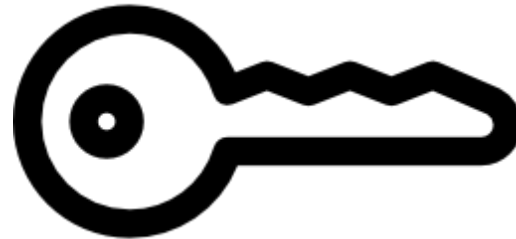

security

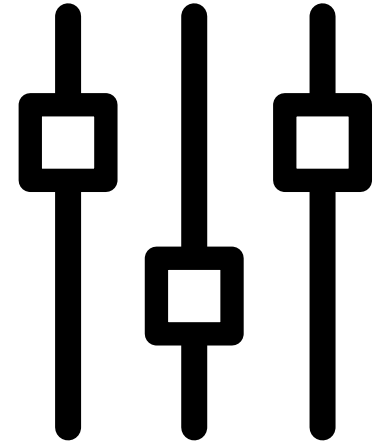

flexibility

# Contact

Piotr Koszelak  
piotr.koszelak@newmap.eu

NewMap  
biuro@newmap.eu

[www.newmap.eu](http://www.newmap.eu)

Icons made by Freepik from [www.flaticon.com](http://www.flaticon.com)

30% discount for orders within a week